



# SPKIT 010 / 010-S

Spare parts - Ersatzteile - Recambios - Pièces détachées - Ricambi - Onderdelen - Varaosat  
 Części zamienne - Rezervni djelovi - Rezervni deli - Reservedeler - 零部件 - قطع الغيار

## ASSEMBLING INSTRUCTIONS AND HELP

### parts + tools

010

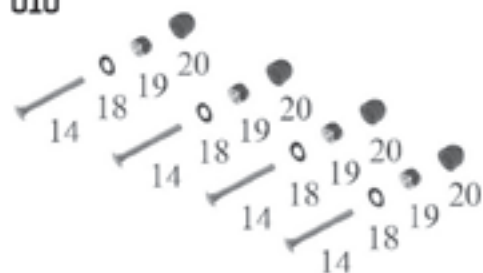

010-S

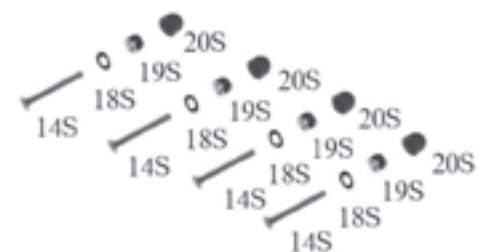

### "How to" - Images

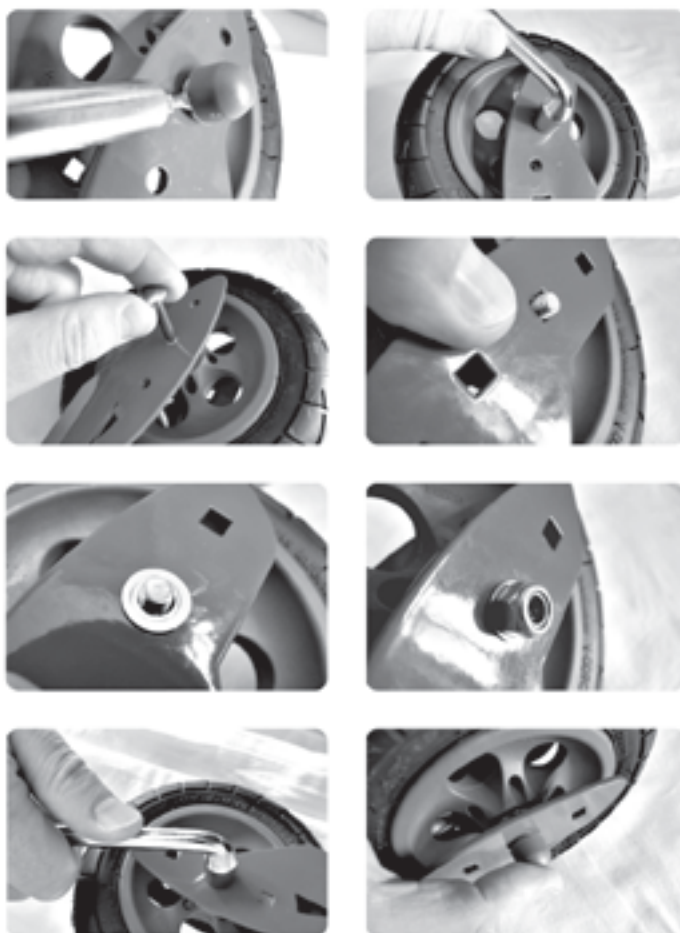

### expert's hints

The skike spare part kit 010 / 010-S has been designed to replace screws that fix the wheels within the frame.

It does not play any role which screw will be used for front and which for rear wheels: All of them are identical, have the same quality and functionality.

Lead the screw at the desired hole through the case. It should point to the direction of the foot the skike is made for. Now put the wheel in between, and finish to the other hole. Put shim and nut onto the screw and start to tighten. Put the plastic cover onto the nut.

Make sure that screws are tightened properly and that the plastic cover point to the outside. Then go for a skike again!